

Kit 1636

LEXUS CT 200h, 5-dr Hatchback, 11-

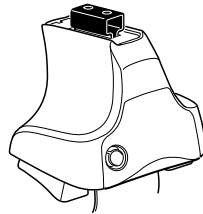

754 Rapid System
480R Rapid Traverse (North America)

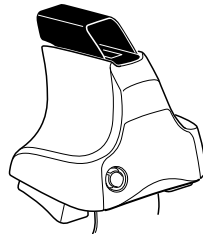
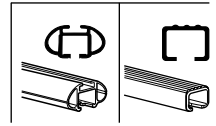

480 Traverse (North America)

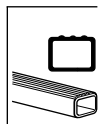

754 Rapid System

480R Rapid Traverse (North America)

480 Traverse (North America)

(North America)

- Component 1: x2
- Component 2: x2 (23 mm)
- Component 3: x2
- Component 4: x4
- Component 5: x4
- Component 6: x1 (17 mm)
- Component 7: x2 (23 mm)
- Component 8: x2
- Component 9: x2
- Component 10: x2
- Component 11: x2 (23 mm)
- Component 12: x2

- Component 1: x2 (1163)
- Component 2: x2 (1164)
- Component 3: x2 (204)
- Component 4: x2 (206)
- Component 5: x1 (RR, PR, FL, RL diagram)

1



2



754 Rapid System
480R Rapid Traverse
(North America)

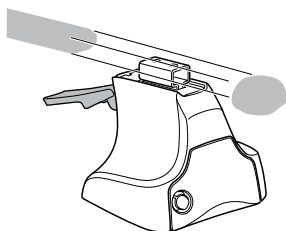

x4

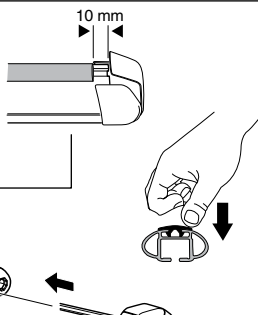
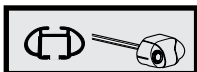

x4

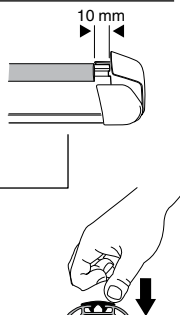
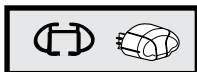

x4



480 Traverse
(North America)

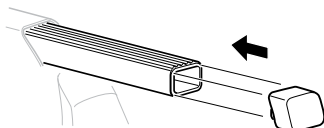
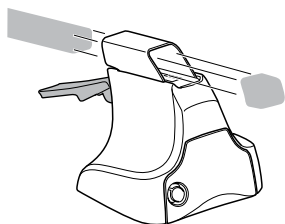

x4

3

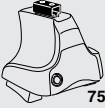

754 Rapid System

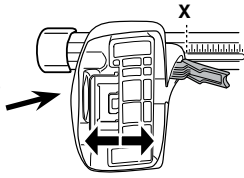

	X
LEXUS CT 200h, 5-dr Hatchback, 11-	29

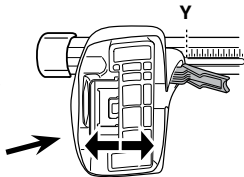

	Y
LEXUS CT 200h, 5-dr Hatchback, 11-	28

3



480R Rapid Traverse



480 Traverse

(North America)

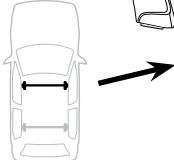

	X inch	X mm
LEXUS CT 200h, 5-dr Hatchback, 11-	37"	941 mm

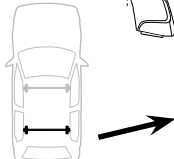

	Y inch	Y mm
LEXUS CT 200h, 5-dr Hatchback, 11-	36 5/8"	931 mm

4

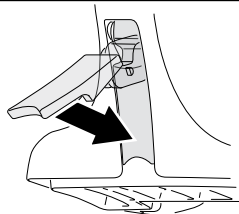

5

LEXUS CT 200h, 5-dr Hatchback, 11-

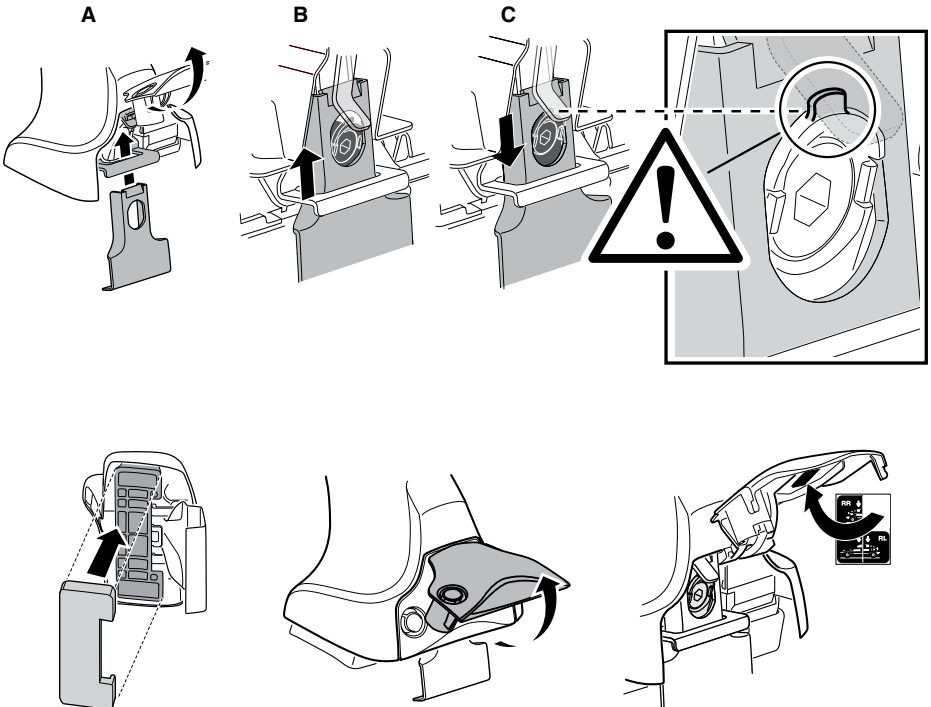
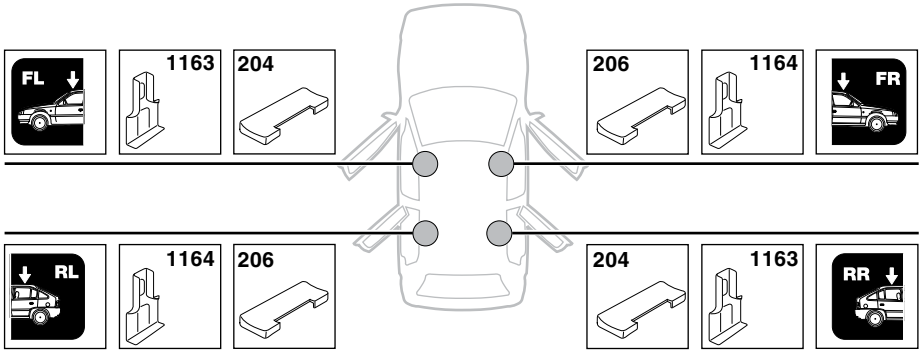

6

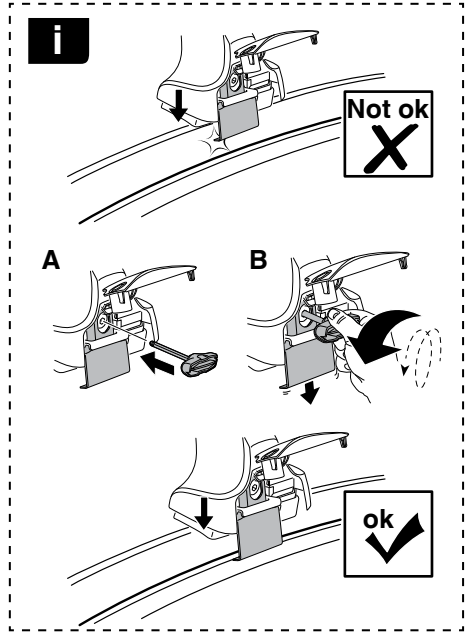

LEXUS CT 200h, 5-dr Hatchback, 11-

X mm

Y mm

X inch

Y inch

200 mm

700 mm

7 7/8"

27 1/2"

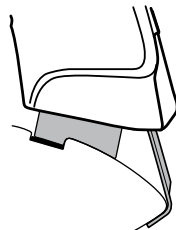
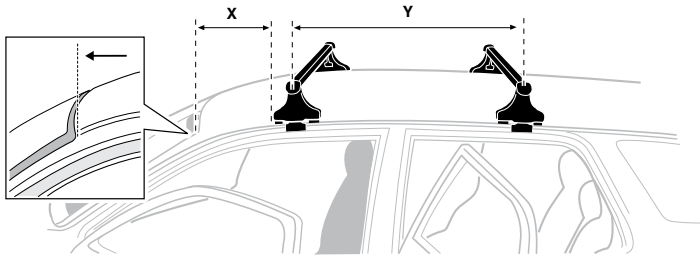

7

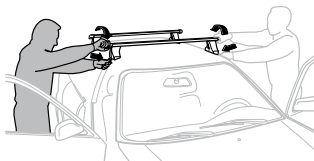

GB/US Tighten alternately
 D Die Schrauben abwechselnd anziehen
 F Serrer alternativement chaque côté
 NL Afwisselend aan de linker- en de rechterkant aandraaien
 I Alternare il serraggio delle viti
 E Apertar alternativamente
 PT Aperte alternadamente
 S Dra åt växelvis
 FIN Kierrä vuorotellen
 EST Pinguldage vaheldumisi
 LAT Pieļieciet pamišus
 LIT Užsukinėkite pakaitomis
 PL Śruby dokręcaj naprzemiennie
 RU Затягивайте попеременно

CZ Pokręťta bagażnika dokręcaj naprzemiennie.
 SK Dofahajte striedavo
 SLO Privijajte izmenično.
 HR Naizmjerno zategnite
 HU Egymástól függetlenül szorítandó
 GR Σφιγίγες εναλλάξ
 TR Dönüşümlü sıkın

中文 交替拧紧

한국어 번갈아 가며 조이십시오.

日本語 交互に締め付けてください。

ไทย ชันในแบบสลับ

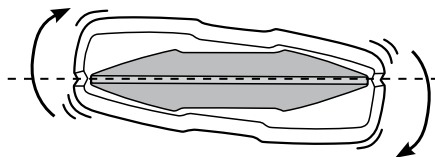
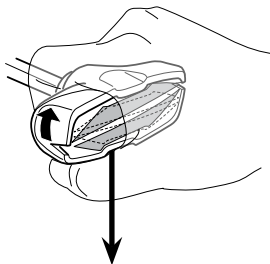
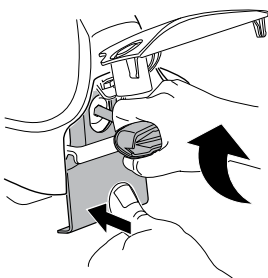
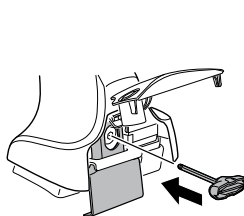

≈ 3 Nm

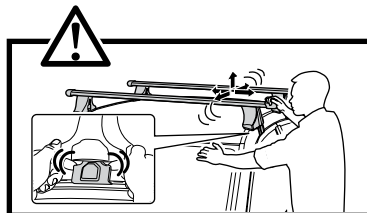
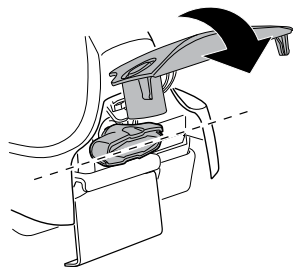

8



x1
17 mm

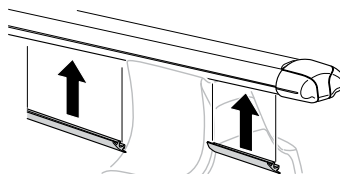
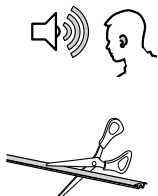

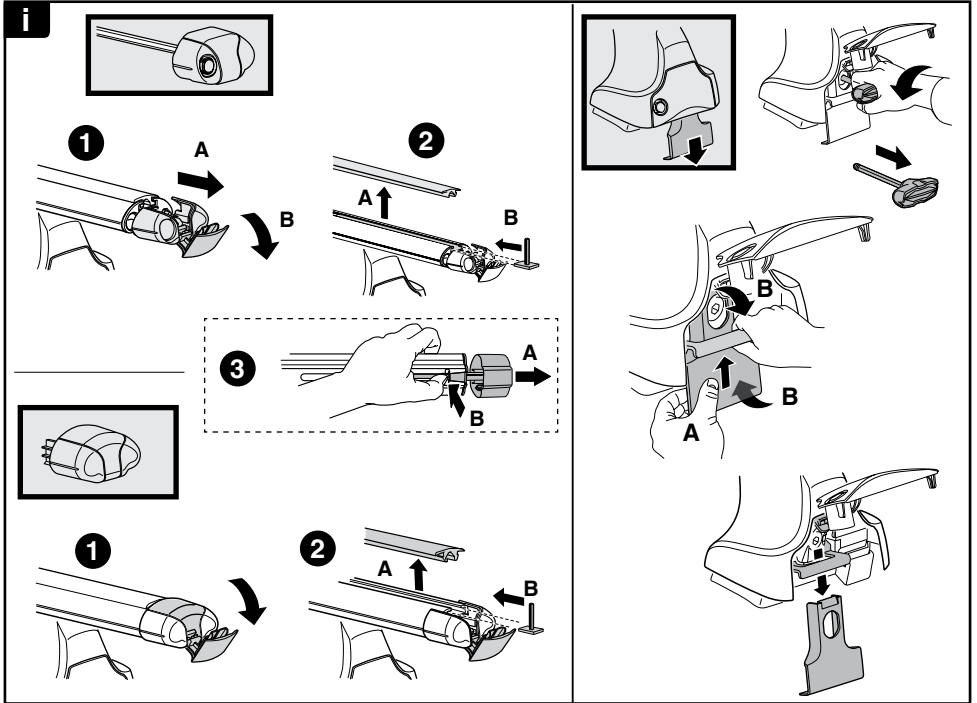
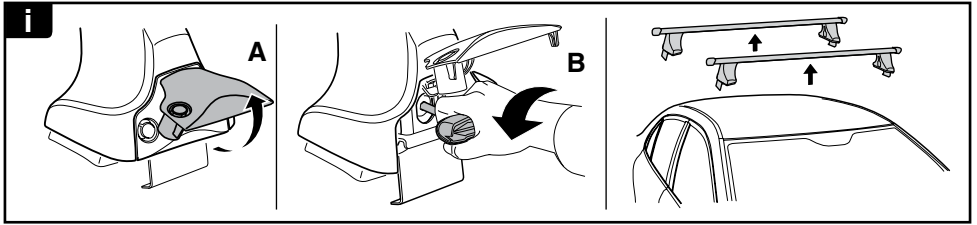

THULE
SWEDEN
**ONE
KEY
SYSTEM**

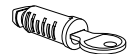
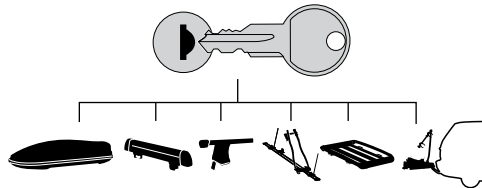

544 (x4)

596 (x6)

588 (x8)

NA **510** (x10)

EUR **452** (x12)

ASIA

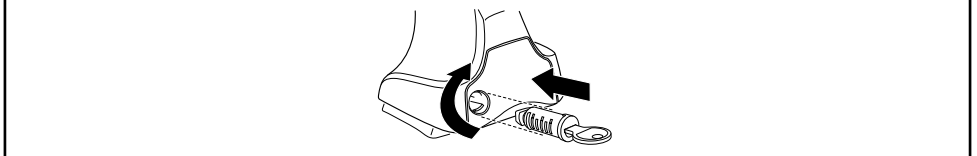

WW ▶ Thule Sweden AB, Box 69, 330 33 Hillerstorp, SWEDEN
NA ▶ Thule Inc., 42 Silvermine Road, Seymour, Connecticut 06483, USA

info@thule.com
customer.service@thule.com

www.thule.com

503-1636-01