

Kit 1593

RENAULT Fluence, 4-dr Sedan, 09–
RENAULT Megane III, 5-dr Hatchback, 09–

480R
754

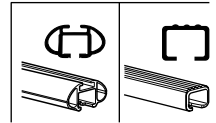
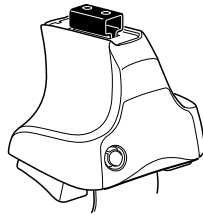

480

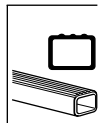
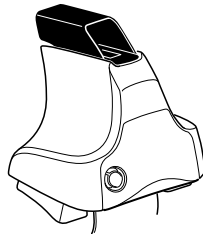

Fluence
 Max.
75 kg / 165 lbs
Megane
 Max.
65 kg / 143 lbs

Kit XXXX

x1
 x4
 x4
 x4
 x4

480R/754

x1
 x4
 x4
 x4

480

x2	x2 23 mm	x1 17 mm	x2 23 mm	x2
x2	x2	x2 23 mm	x2	
x4	x4	x2		
		x4		

1084 x4
 251 x1
 x1

196 x2
 252 x1

Kit

1

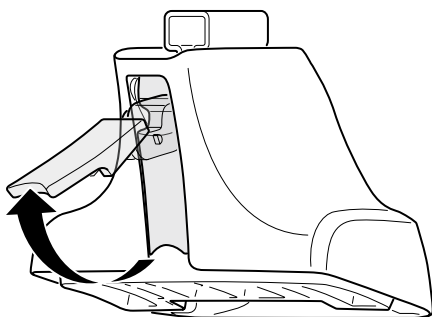
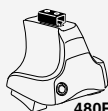

2

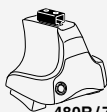

+

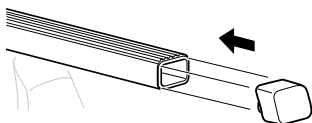
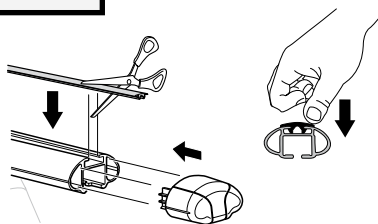
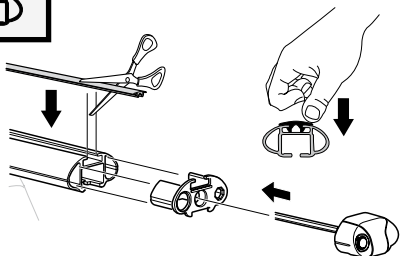
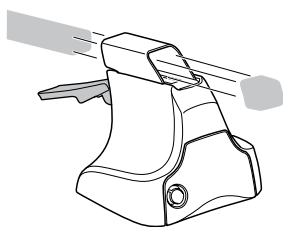
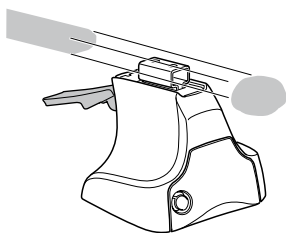

3

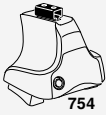

754

1

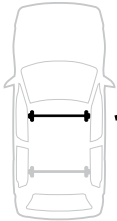

1

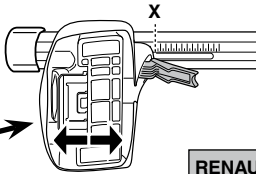

2

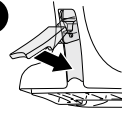

	X
RENAULT Fluence, 4-dr Sedan, 09-	37
RENAULT Megane III, 5-dr Hatchback, 09-	36

1

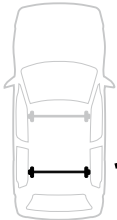

1

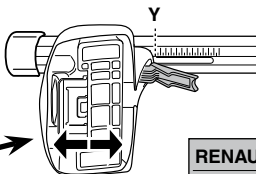

2

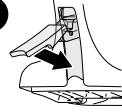

	Y
RENAULT Fluence, 4-dr Sedan, 09-	33
RENAULT Megane III, 5-dr Hatchback, 09-	32,5

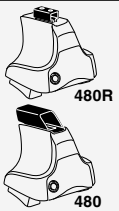

480R

480

1

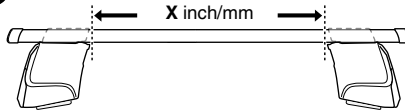
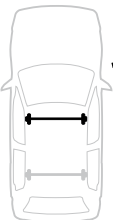

2

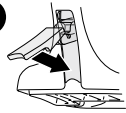

	X inch	X mm
RENAULT Fluence, 4-dr Sedan, 09-	40 1/4"	1021 mm
RENAULT Megane III, 5-dr Hatchback, 09-	39 3/4"	1011 mm

1

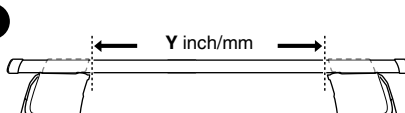

2

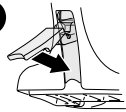

	Y inch	Y mm
RENAULT Fluence, 4-dr Sedan, 09-	38 5/8"	981 mm
RENAULT Megane III, 5-dr Hatchback, 09-	38 3/8"	976 mm

4

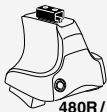

480R/754



480

RENAULT Fluence, 4-dr Sedan, 09–
RENAULT Megane III, 5-dr Hatchback, 09–

251



1084



252



1084



196



1084



196



1084

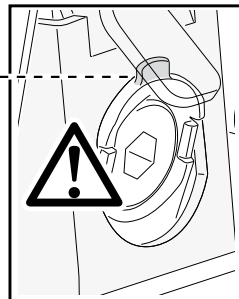
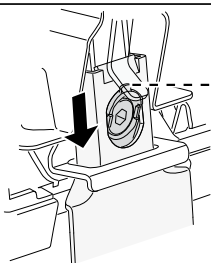
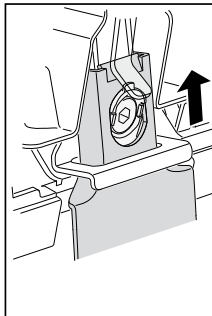
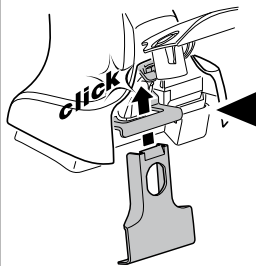
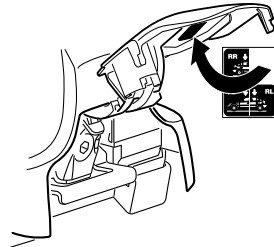
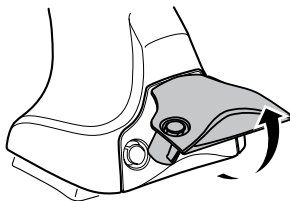
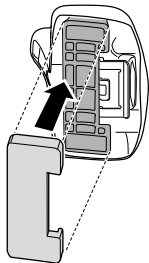

5



	X mm	Y mm	X inch	Y inch
RENAULT Fluence, 4-dr Sedan, 09–	110 mm	735 mm	4 3/8"	28 7/8"
RENAULT Megane III, 5-dr Hatchback, 09–	120 mm	760 mm	4 3/4"	29 7/8"

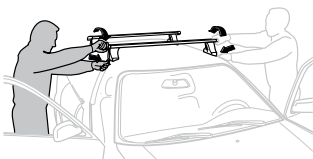
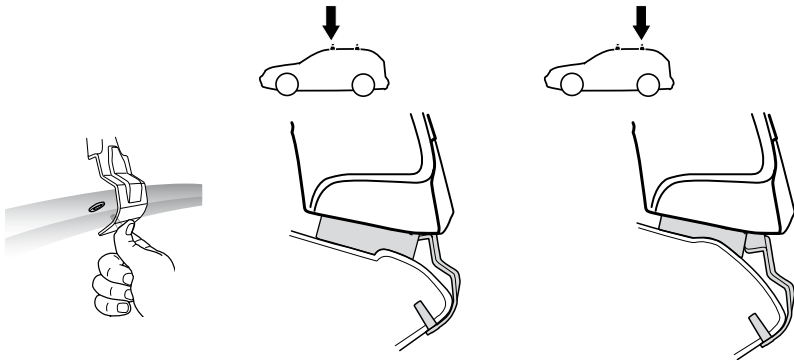
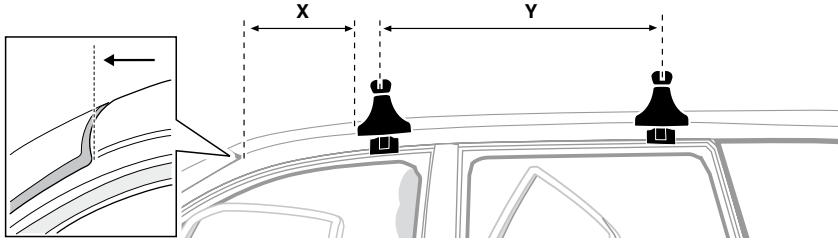

- | | | | |
|--------------|---|------------|--|
| GB/US | Tighten alternately | CZ | Pokrétla багаžníka dokręčaj dokręčaj naprziemiennie. |
| D | Die Schrauben abwechselnd anziehen | SK | Dofahujte striedavo |
| F | Serrer alternativement chaque côté | SLO | Privijajte izmenično. |
| NL | Afwisselend aan de linker- en de rechterkant aandraaien | HR | Naizmjenično zategnite |
| I | Alternare il serraggio delle viti | HU | Egymástól függetlenül szorítandó |
| E | Apretar alternativamente | GR | Σφιγίγτες εναλλάξ |
| PT | Aperte alternadamente | TR | Dönüşümlü sıkın |
| S | Dra åt växelvis | 中文 | 交替拧紧 |
| FIN | Kierrä vuorotellen | 한국어 | 번갈아 가며 조이십시오. |
| EST | Pinguldage vaheldumisi | 日本語 | 交互に締め付けてください。 |
| LAT | Pievelciet pamišus | ไทย | ขันในแบบสลับ |
| LIT | Užsukinkite pakaitomis | | |
| PL | Śruby dokręcaj naprzemiennie | | |
| RU | Затягивайте попеременно | | |

6

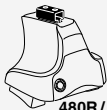

480R/754



480

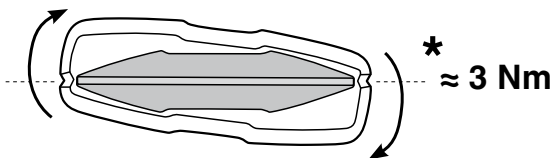
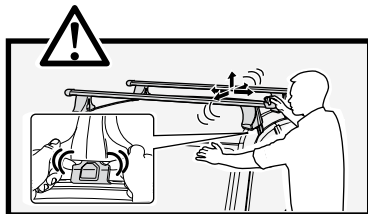
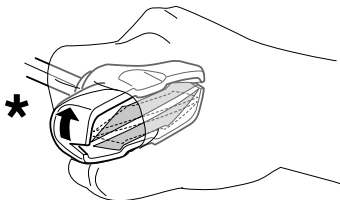
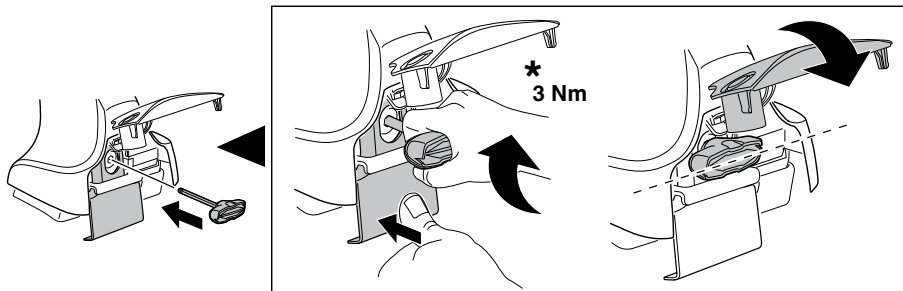

7

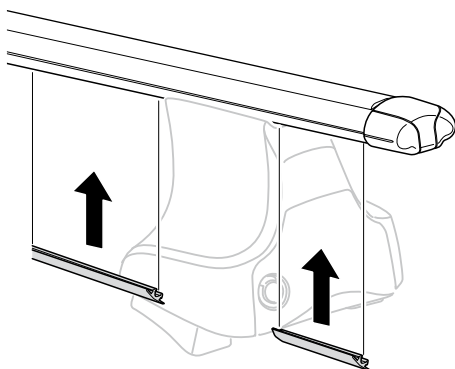
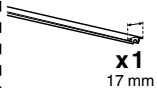

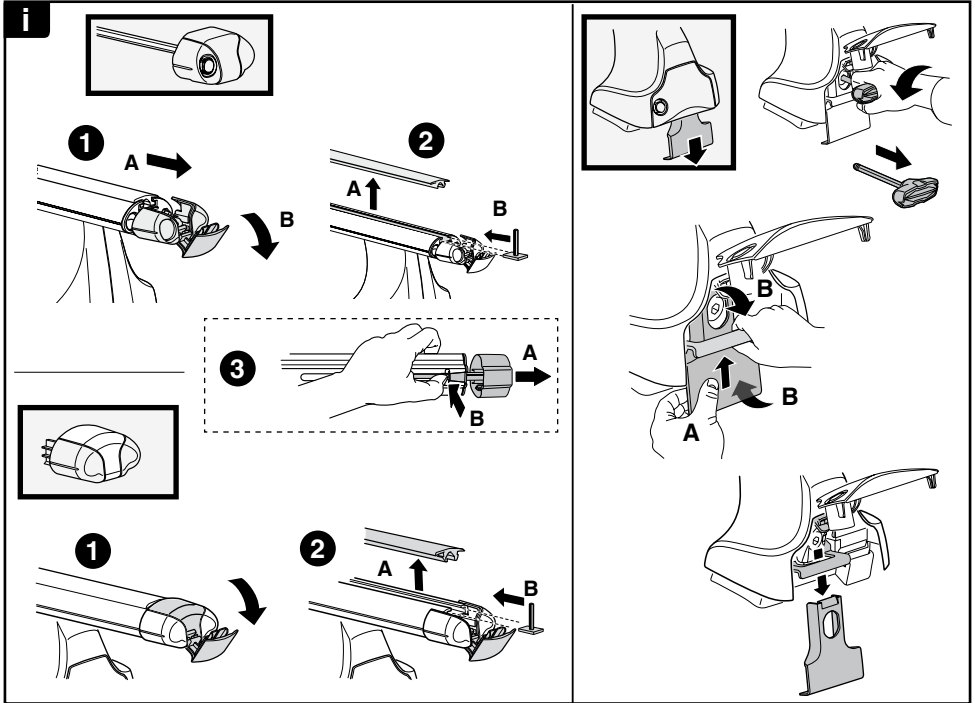

THULE
SWEDEN
**ONE
KEY
SYSTEM**

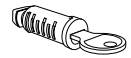
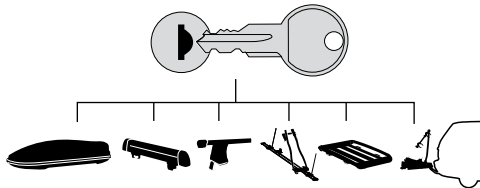

- 544** (x4)
- 596** (x6)
- 588** (x8)
- NA **510** (x10)
- EUR **452** (x12)
- ASIA

