

# Kit 1579

**KIA Cerato**, 4-dr Sedan, 08–

**KIA Forte**, 4-dr Sedan, 08– / \*10–

\*North America

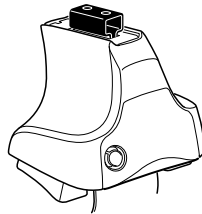

**754** Rapid System  
**480R** Rapid Traverse (North America)

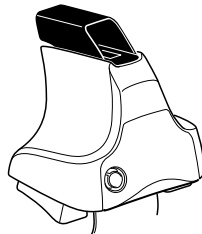
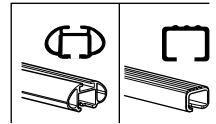

**480** Traverse (North America)

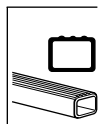

754 Rapid System  
 480R Rapid Traverse (North America)

480 Traverse (North America)

(North America)

- 2 x 23 mm nuts
- 2 x 17 mm nuts
- 2 x 23 mm nuts
- 4 x screws
- 4 x washers
- 1 x 17 mm nut
- 2 x 23 mm nuts
- 2 x 23 mm nuts
- 2 x 23 mm nuts
- 2 x 23 mm nuts
- 2 x 23 mm nuts
- 2 x 23 mm nuts

1107 x2  
 1108 x2  
 191 x2  
 192 x2  
 x1

1

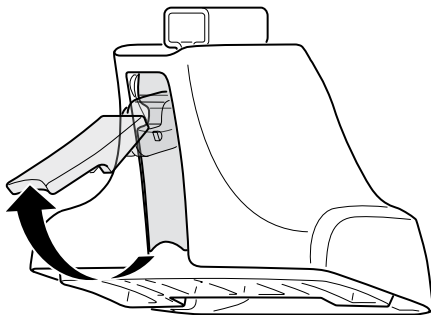

2



754 Rapid System  
480R Rapid Traverse  
(North America)

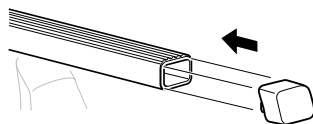
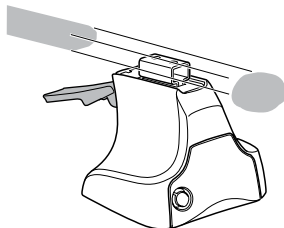

x4

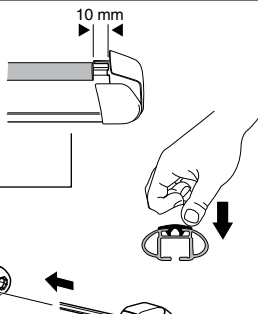

x4

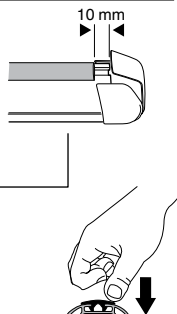
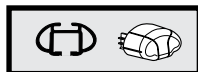

x4



480 Traverse  
(North America)

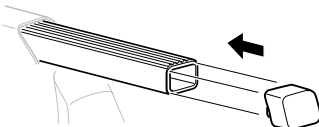

x4

**3**



**754** Rapid System



	X
<b>KIA Cerato, 4-dr Sedan, 08-</b>	<b>38,5</b>
<b>KIA Forte, 4-dr Sedan, 08- / *10-</b>	<b>38,5</b>

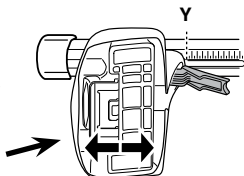

	Y
<b>KIA Cerato, 4-dr Sedan, 08-</b>	<b>36,5</b>
<b>KIA Forte, 4-dr Sedan, 08- / *10-</b>	<b>36,5</b>

**3**



**480R** Rapid Traverse



**480** Traverse

**(North America)**

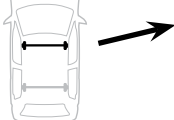

	X inch	X mm
<b>KIA Cerato, 4-dr Sedan, 08-</b>	<b>40 3/4"</b>	<b>1036 mm</b>
<b>KIA Forte, 4-dr Sedan, 08- / *10-</b>	<b>40 3/4"</b>	<b>1036 mm</b>

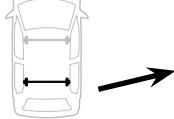

	Y inch	Y mm
<b>KIA Cerato, 4-dr Sedan, 08-</b>	<b>40"</b>	<b>1015 mm</b>
<b>KIA Forte, 4-dr Sedan, 08- / *10-</b>	<b>40"</b>	<b>1015 mm</b>

**4**

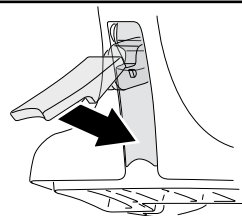

**5**

**KIA Cerato, 4-dr Sedan, 08–**  
**KIA Forte, 4-dr Sedan, 08– / \*10–**

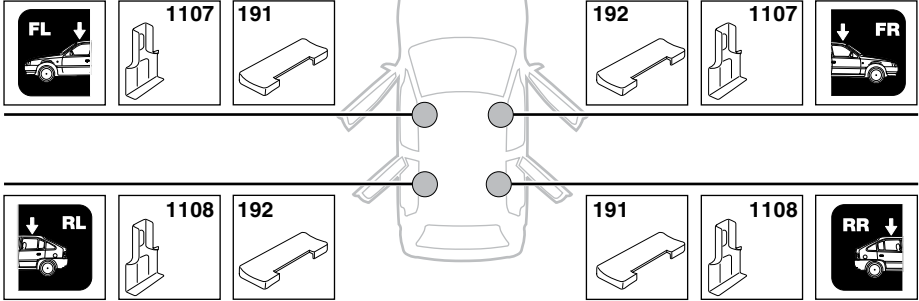

6

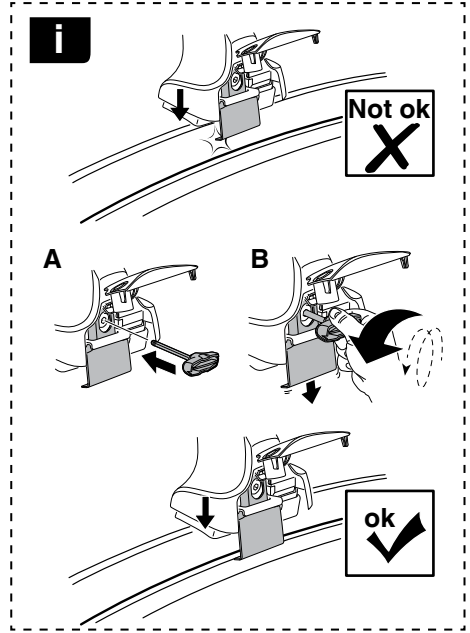

	X mm	Y mm	X inch	Y inch
KIA Cerato, 4-dr Sedan, 08-	260 mm	660 mm	10 1/4"	26"
KIA Forte, 4-dr Sedan, 08- / *10-	260 mm	660 mm	10 1/4"	26"

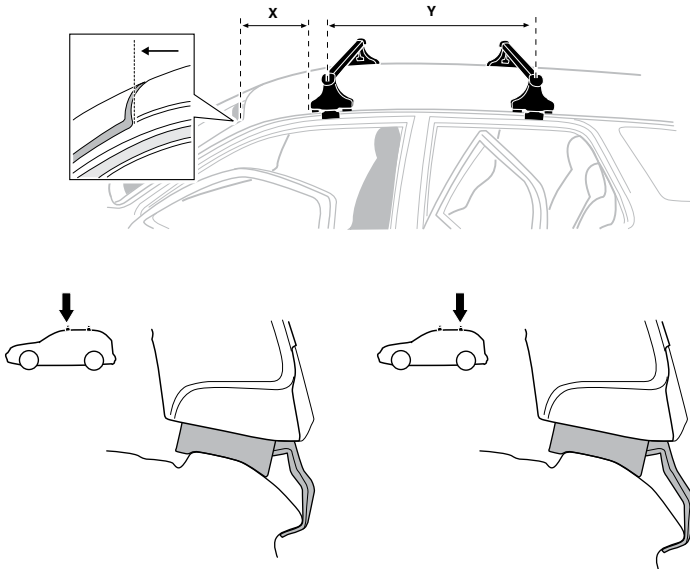

7

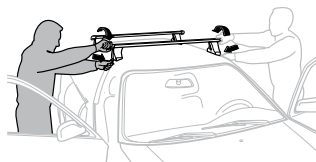

<b>GB/US</b>	Tighten alternately
<b>D</b>	Die Schrauben abwechselnd anziehen
<b>F</b>	Serrer alternativement chaque côté
<b>NL</b>	Afwisselend aan de linker- en de rechterkant aandraaien
<b>I</b>	Alternare il serraggio delle viti
<b>E</b>	Apertar alternativamente
<b>PT</b>	Aperte alternadamente
<b>S</b>	Dra åt växelvis
<b>FIN</b>	Kierrä vuorotellen
<b>EST</b>	Pinguldage vaheldumisi
<b>LAT</b>	Pielveiciet pamišus
<b>LIT</b>	Užsukinėkite pakaitomis
<b>PL</b>	Śruby dokręcaj naprzemiennie
<b>RU</b>	Загряивайте попеременно

<b>CZ</b>	Pokręřta багаžníka dokręřcaj dokręřcaj naprzemiennie.
<b>SK</b>	Dofahajte striedavo
<b>SLO</b>	Privijajte izmenično.
<b>HR</b>	Naizmjenočno zategnite
<b>HU</b>	Egymástól függetlenül szorítandó
<b>GR</b>	Σφιγίγτες εναλλάξ
<b>TR</b>	Dönüşümlü sıkın

**中文** 交替拧紧

**한국어** 번갈아 가며 조이십시오.

**日本語** 交互に締め付けてください。

**ไทย** ชันในแบบสลับ

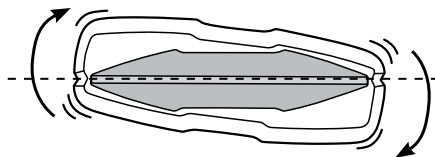
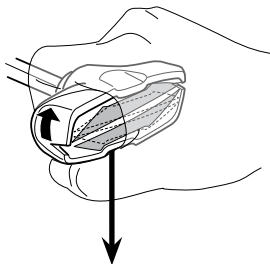
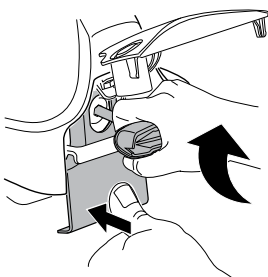
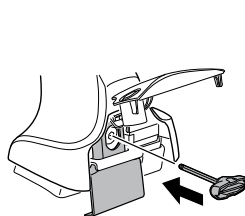

≈ 3 Nm

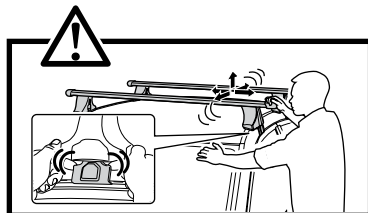
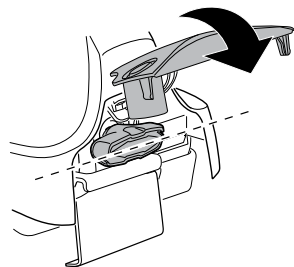

8

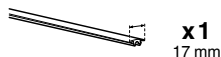

x1  
17 mm

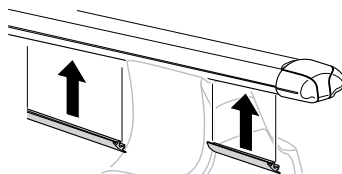
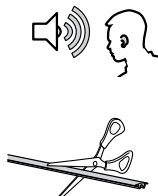

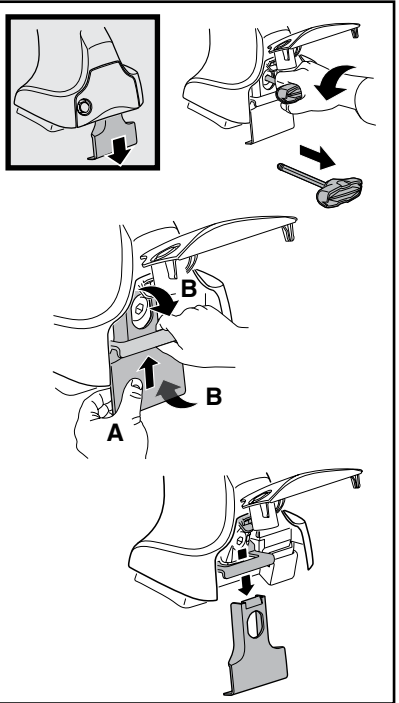
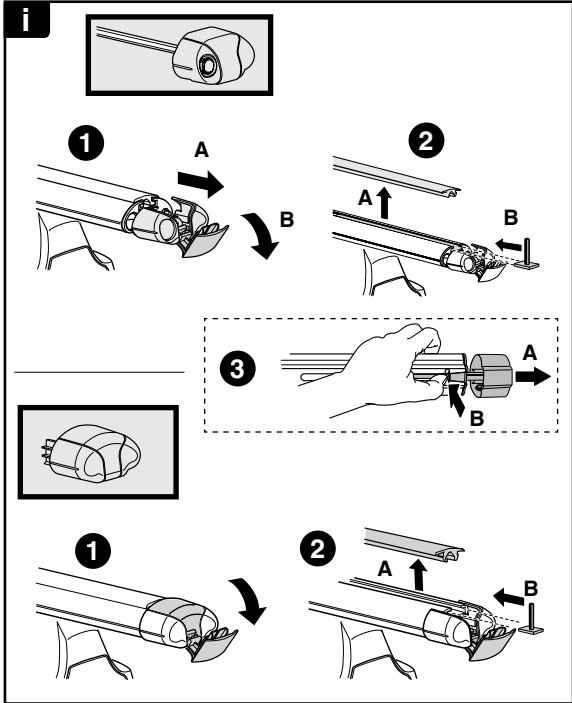

**THULE**  
SWEDEN  
**ONE  
KEY  
SYSTEM**

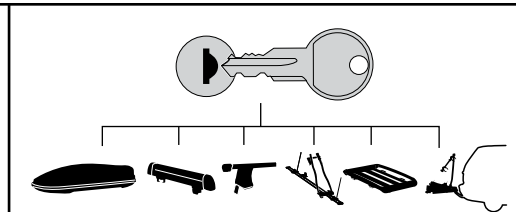

		(x4)
		(x6)
		(x8)
NA		(x10)
EUR		(x12)
ASIA		

