

Kit 1577

HYUNDAI Sonata Y20, 4-dr Sedan, 10-
HYUNDAI Sonata i40, 4-dr Sedan, 10-
HYUNDAI i45, 4-dr Sedan, 10-

480R
754

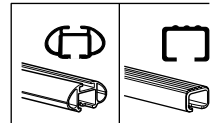
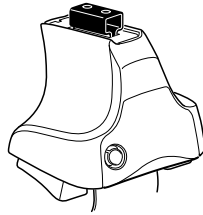

480

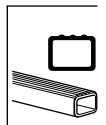
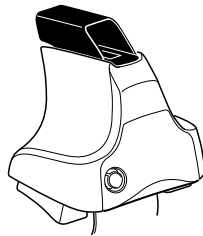

1

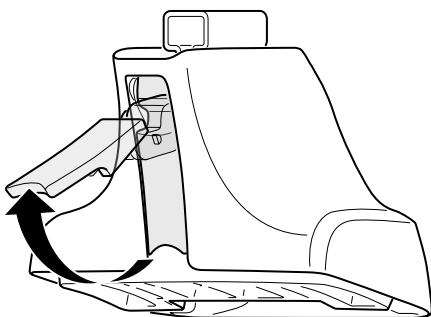
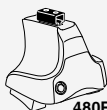

2



+

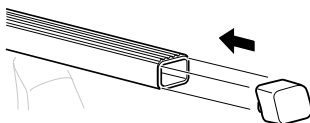
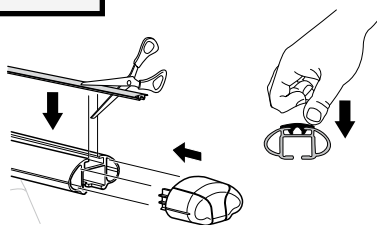
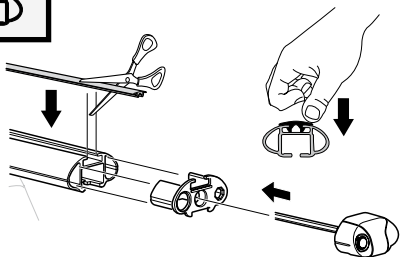
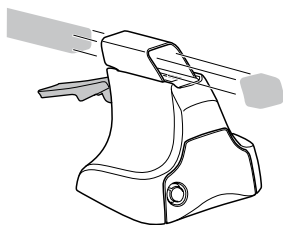
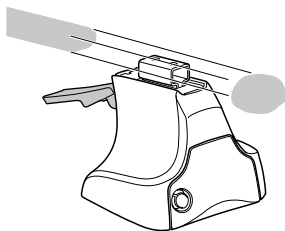

3

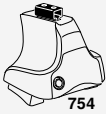

754

1

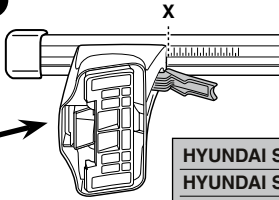
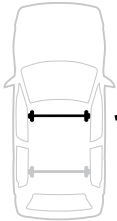

2

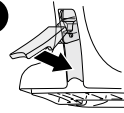

	X
HYUNDAI Sonata Y20, 4-dr Sedan, 10-	42
HYUNDAI Sonata i40, 4-dr Sedan, 10-	42
HYUNDAI i45, 4-dr Sedan, 10-	42

1

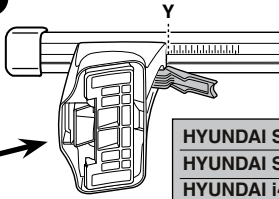

2

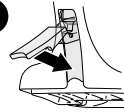

	Y
HYUNDAI Sonata Y20, 4-dr Sedan, 10-	40
HYUNDAI Sonata i40, 4-dr Sedan, 10-	40
HYUNDAI i45, 4-dr Sedan, 10-	40



480R

480

1

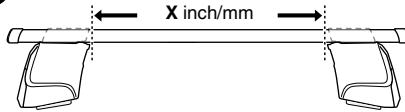
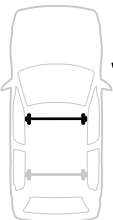

2

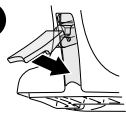

	X inch	X mm
HYUNDAI Sonata Y20, 4-dr Sedan, 10-	42 1/8"	1071 mm
HYUNDAI Sonata i40, 4-dr Sedan, 10-	42 1/8"	1071 mm
HYUNDAI i45, 4-dr Sedan, 10-	42 1/8"	1071 mm

1

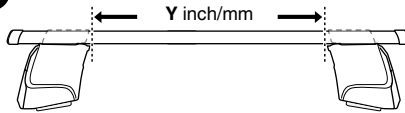

2

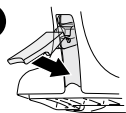

	Y inch	Y mm
HYUNDAI Sonata Y20, 4-dr Sedan, 10-	41 3/8"	1051 mm
HYUNDAI Sonata i40, 4-dr Sedan, 10-	41 3/8"	1051 mm
HYUNDAI i45, 4-dr Sedan, 10-	41 3/8"	1051 mm

4



480R/754



480

HYUNDAI Sonata Y20, 4-dr Sedan, 10-
HYUNDAI Sonata i40, 4-dr Sedan, 10-
HYUNDAI i45, 4-dr Sedan, 10-

336



1064



FL



337



1065



FR



337



1066



RL



336



1067



RR

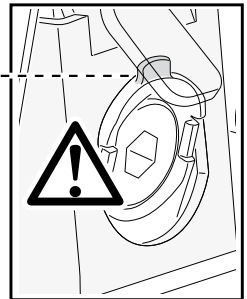
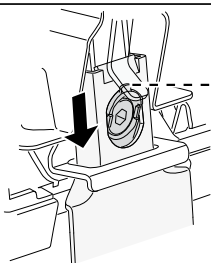
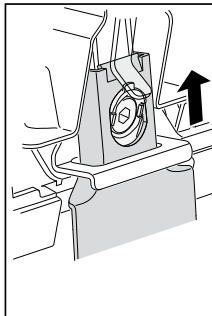
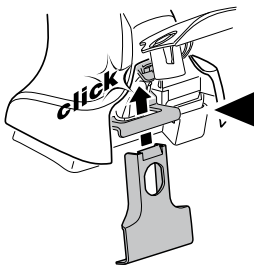
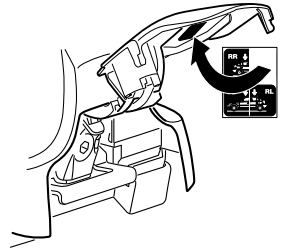
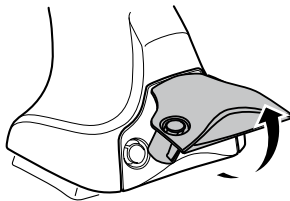
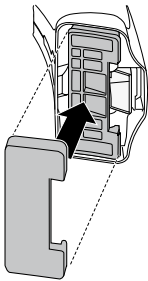

5

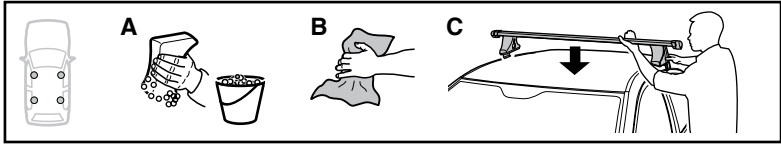

	X mm	Y mm	X inch	Y inch
HYUNDAI Sonata Y20, 4-dr Sedan, 10-	340 mm	700 mm	13 3/8"	27 1/2"
HYUNDAI Sonata i40, 4-dr Sedan, 10-	340 mm	700 mm	13 3/8"	27 1/2"
HYUNDAI i45, 4-dr Sedan, 10-	340 mm	700 mm	13 3/8"	27 1/2"

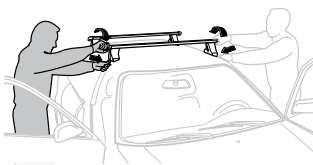
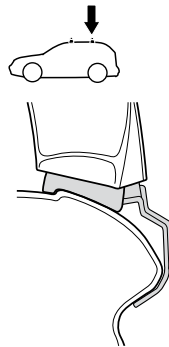
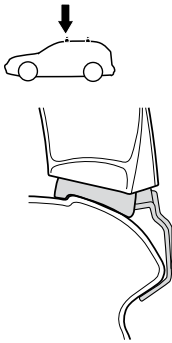
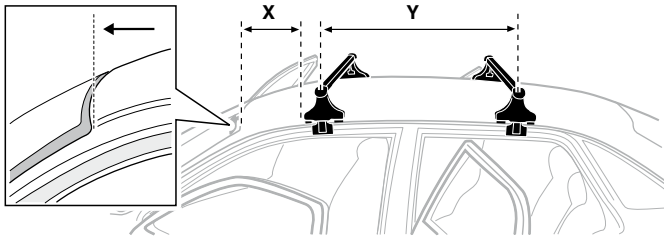

- GB/US** Tighten alternately
D Die Schrauben abwechselnd anziehen
F Serrer alternativement chaque côté
NL Afwisselend aan de linker- en de rechterkant aandraaien
I Alternare il serraggio delle viti
E Apretar alternativamente
PT Aperte alternadamente
S Dra åt växelvis
FIN Kierrä vuorotellen
EST Pinguldage vaheldumisi
LAT Pievelciēt pamišus
LIT Užsukinėkite pakaitomis
PL Śruby dokręcaj naprzemiennie
RU Затягивайте попеременно

- CZ** Pokrétla bagazníka dokręcaj dokręcaj naprzemiennie.
SK Dotiahujte striedavo
SLO Privijajte izmenično.
HR Naizmjenično zategnite
HU Egymástól függetlenül szorítandó
GR Σφιγγετε εναλλάξ
TR Dönüşümlü sıkın

中文 交替拧紧

한국어 번갈아 가며 조이십시오.

日本語 交互に締め付けてください。

ไทย ขึ้นในแบบสลับ

6

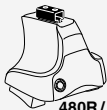

480R/754



480

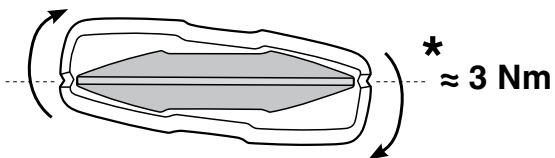
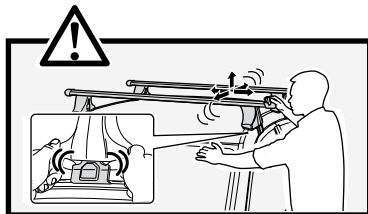
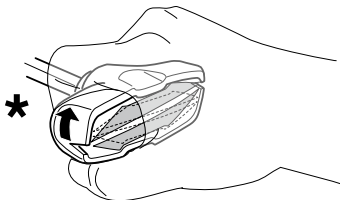
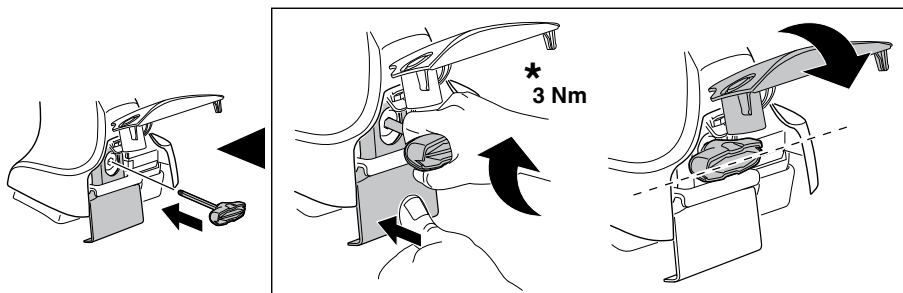

7

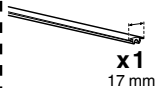

x1
17 mm

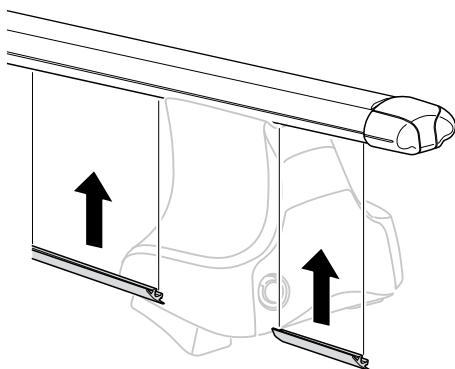

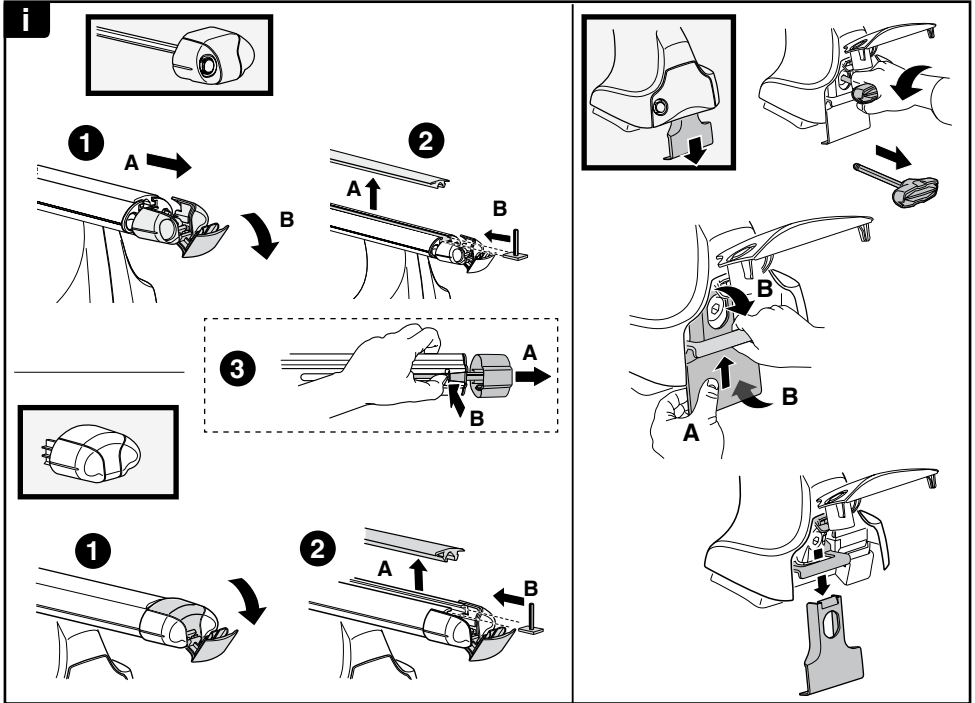
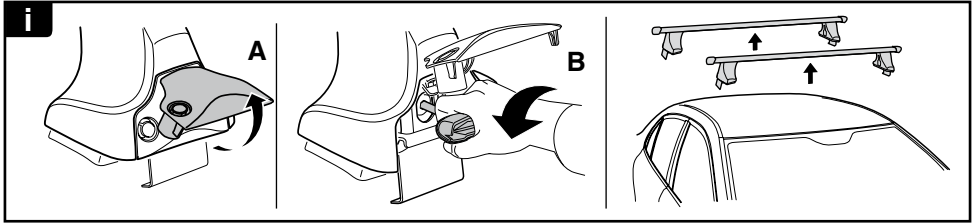

THULE
SWEDEN
**ONE
KEY
SYSTEM**

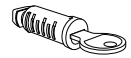
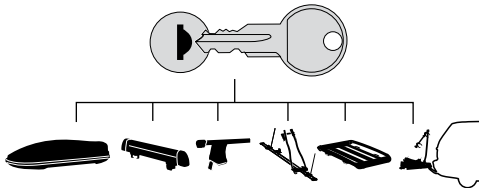

- 544** (x4)
- 596** (x6)
- 588** (x8)
- NA **510** (x10)
- EUR **452** (x12)
- ASIA

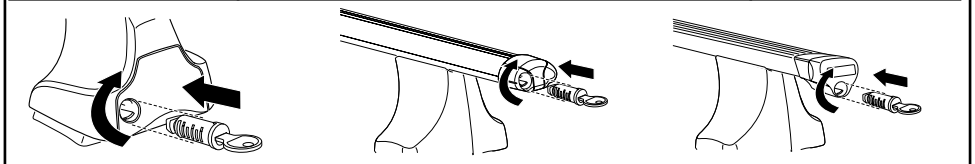

WW ▶ Thule Sweden AB, Box 69, 330 33 Hillerstorp, SWEDEN
NA ▶ Thule Inc., 42 Silvermine Road, Seymour, Connecticut 06483, USA

info@thule.com
customer.service@thule.com

www.thule.com

503-1577-03